

Rotary(Connection Type)

UT HEAD

Interchangeable with UM23, UM21 and UM20

UT01 Standard Head



Weight: 115g

UT02 Slender Head



Weight: 100g

UT03 Power Rotary Head



Weight: 150g

UT11 Long Slender Head



Weight: 115g

UT12 Standard Clamp Head



Weight: 100g

TYPE	COLLET SIZE(mm)		
	MOUNTED	INCLUDED	OPTION
UT01,UT02	φ 2.34 (Item No.KP-036B)	φ 3.0 (Item No.KP-032B)	φ 3.175 (Item No.KP-033B)
UT03	φ 6.0 (Item No.KP-060)	φ 3.0 (Item No.KP-062)	φ 2.34 (Item No.KP-061) φ 3.175 (Item No.KP-063) φ 6.35 (Item No.KP-064)
UT11,UT12	φ 3.0 (Item No.KP-032B)	φ 2.34 (Item No.KP-036B)	φ 3.175 (Item No.KP-033B)

Interchangeable with UM21 and UM20

UT05 Angle Head 90°



Weight: 115g

UT06 Power Angle Head 90°



Weight: 100g

UT07 Power Angle Head 120°



Weight: 150g

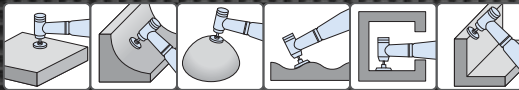

TYPE	COLLET SIZE(mm)		
	MOUNTED	INCLUDED	OPTION
UT05	φ 3.0 (Item No.KP-022)	φ 2.34 (Item No.KP-021)	φ 3.175 (Item No.KP-025)
UT06,UT07	φ 3.0 (Item No.KP-032B)	φ 2.34 (Item No.KP-036B)	φ 3.175 (Item No.KP-033B)

Interchangeable with UM20

UT08 Swing Head

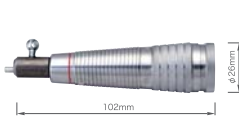

Weight: 115g

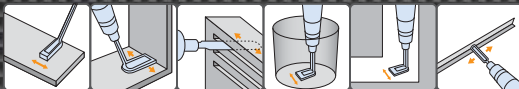

Instead of collet system, V ditch chuck is adopted : possible to attach the tool of φ 2-4mm. Also, possible to attach the tool of the triangle and the square handle.

The tool is optional item.

FULL CHOICE SYSTEM

UM MOTOR

UT15



1/4 Reduction Joint
To be connected between Motor-unit and Head-unit.

UM23



Weight: 170g not including motor cord

Speed : 3,000~30,000rpm
Max.torque : 650g · cm (6.5 N · cm)

UM21



Weight: 170g not including motor cord

Speed : 1,500~15,000rpm
Max.torque : 900g · cm (8.8 N · cm)

UM20



Weight: 170g not including motor cord

Speed : 800~8,000rpm
Max.torque : 900g · cm (8.8 N · cm)

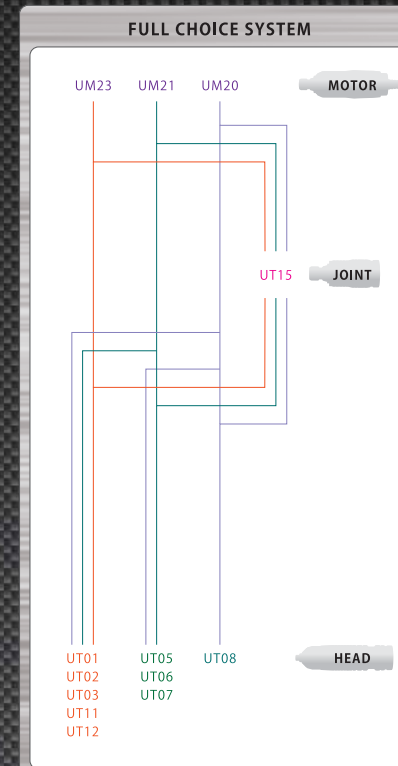

The Handpiece Stand is included in UM motor series.
(Item No.KP90-101)



Rotary Handpiece (One-Piece Type)

UA12A, UA13A, UA14A, UA05A



	UA12A	UA13A	UA14A	UA05A
Speed	2,000~ 20,000rpm	3,500~ 35,000rpm	4,500~ 45,000rpm	5,500~ 55,000rpm
Max Torque	660g · cm (6.5N · cm)	550g · cm (5.4N · cm)	420g · cm (4.1N · cm)	330g · cm (3.2N · cm)
Mounted Collet	φ 2.34mm (KP-036B)			
Enclosed Collet	φ 3.0mm (KP-032B)			
Option Collet	φ 3.175mm (KP-033B)			
Accessories	<p>The Handpiece Stand (KP90-101)</p>			

- The head and the motor are not interchangeable in "UA" series but the rotating centering accuracy increases to the maximum.
- Well-designed "Pencil" to use easily with a goods balance, which ensures comfortable working.
- Motor unit incorporates a Self-Cooling Fan.

Recipro Handpiece

RE35, RE55

This tool is optional item.



Width:40mm
Weight:675g not including motor cord

	RE35 Stroke Type	RE55 Speed Type
Reciprocating Stroke	0 - 6mm	0 - 2mm
Frequency	420~4,200 strokes/min	700~7,000 strokes/min

- Reciprocating Stroke.
- Tool holder accepts tool shanks from φ 2.0~φ 6.35mm.
- The locking mechanism allows for fixed or free-floating operation.
- Motor unit incorporates a Self-Cooling Fan.

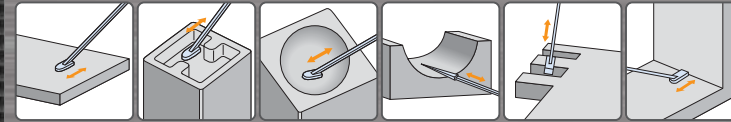

Hammer Handpiece

HM11



Stroke	0.7mm
Impact Frequency	0~32Hz
Impact Force	Max.392m/s2 (40G)
Accessories	<p>The Handpiece Stand (KP90-101)</p> <p>Tool (HM10-151)</p> <p>Tool adapter B (HM10-154)</p> <p>Adapter for the tool polish (KP43-101)</p> <p>* A wrench is enclosed for tool exchange.</p>

- Recommended for inlaying jewelry, riveting ring and pendant or blacksmith.
- Possible to use just as tool edge is toughed to the spot.
- Possible to adjust in the wide range of frequency or stress.
- Motor unit incorporates a Self-Cooling Fan.

Belt Sander

BS33

The polish belt is optional item.



Width:40mm
Weight:400g not including motor cord

Belt Speed	77.7~777m/min
Thin Belt Arm (BS1-100-1)	<p>* Belt Width : 4~6mm</p>
Standard Belt Arm (BS1-100-2)	<p>* Belt Width : 6~8mm</p>
Angle Arm (BS1-100-3)	<p>* Belt Width : 6~8mm</p>

- Suitable for a wide variety of applications that range from deburring to polishing.
- The different type of Belt Arms allow for maximum versatility.
- The Belt Arm incorporates a spring-loaded mechanism that enables the rapid changing of abrasive belts.
- Motor unit incorporates a Self-Cooling Fan.

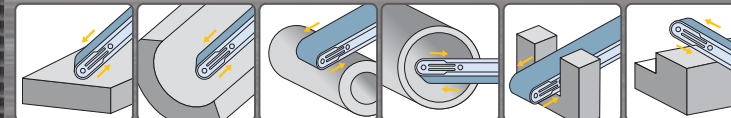

Ultrasonic Handpiece

US55

Any tool-tip is provided; please refer to our tool catalogue.



Weight: 180g not including motor cord

- A compact-sized & light weighted handpiece ergonomically designed to enhance the operational efficiency, not causing fatigue even after works for long times.
- Applications include the finishing of plastic moulds, diecasts, presstools, ceramic, nonferrous and precious metals. Ideal for deburring, polishing and removing EDM scales.
- The tip of tool vibrates back and forth within amplitude of maximum 45 micron to lap grooves, ribs and hard-to-reach spots by hand.
- Available with Hybrid Controller UC550 series only.

US55	
Transducer	Langevin Type
Amplitude	45um
Accessories	Holder Changing Wrench (HK-8)
	Tool Changing Wrench (HS-1.5)(HS-2.5)

Hybrid Control

UC550

Folder angles can be adjusted as follows:



- Automatic feed system is incorporated to adjust the frequency depending on the tool being used.
- 4 stages safety circuit are built in to preclude the probability of over-heating or overloading in both controller and handpiece.
- Motor rotation can be reversed at a touch.
- Quick stop circuit system enables the handpiece to stop as soon as the operator removes his/her foot from VC10, F518, or turns off the power switch.

UC550			
Type	UC550C	UC551C	UC553C
Input	AC100V 50/60Hz 30VA	AC120V 50/60Hz 30VA	AC230V 50/60Hz 30VA
Output	Ultrasonic Handpiece : AC6~60V 22.6kHz 0.3A Motor Handpiece : DC3~30V 0.3A		
Accessories	The Handpiece Stand (KP90-101)		

High Power Controller

UC500

Folder angles can be adjusted as follows:



UC500 High Power Controller accepts all Handpieces. (Two handpieces can not be used simultaneously.)

- Automatic feedback circuit that ensures constant revolutions under a variety of working conditions.
- The following safety features are provided:
 - (1) A fuse to safeguard against an AC circuit short or an abnormal electric current in the primary circuit.
 - (2) A thermal fuse is located in the transformer to protect against overheating.
 - (3) A thermal sensor that temporarily switches off the current in the event
 - (4) An electronic circuit breaker that will temporarily stop the current in the event of an excessive load being applied to the handpiece.
- Dust proof system for all controls.
- Variable Foot Controller (VC10) and On-Off Foot Switch (F518) are optional.
- Quick stop circuit system enables the handpiece to stop as soon as the operator removes his/her foot from VC10, F518, or turns off the power switch.

UC500			
Type	UC500C	UC501C	UC503C
Input	AC100V 50/60Hz 30VA	AC120V 50/60Hz 30VA	AC230V 50/60Hz 30VA
Output	DC3~30V 0.3A×2		
Standard Accessories	Handpiece Holder(2 pcs) (PA31-748)		

Power Controller

UC250



UC250 Power Controller accepts all Handpieces.

- Automatic feedback circuit that ensures constant revolutions under a variety of working conditions.
- The following safety features are provided:
 - (1) A fuse to safeguard against an AC circuit short or an abnormal electric current in the primary circuit.
 - (2) A thermal fuse is located in the transformer to protect against overheating.
 - (3) A thermal sensor that temporarily switches off the current in the event
 - (4) An electronic circuit breaker that will temporarily stop the current in the event of an excessive load being applied to the handpiece.
- Dust proof system for all controls.
- Variable Foot Controller (VC10) and On-Off Foot Switch (F518) are optional.
- Quick stop circuit system enables the handpiece to stop as soon as the operator removes his/her foot from VC10, F518, or turns off the power switch.

UC250			
Type	UC250C	UC251C	UC253C
Input	AC100V 50/60Hz 24VA	AC120V 50/60Hz 24VA	AC230V 50/60Hz 24VA
Output	DC3~30V 0.3A		
Feature	UC250		

Optional Accessories

VC60
Variable Foot Controller



Weight: 115g

Possible to control rotation speed from the start to max. speed as if driven by a car accelerator.

FS18
ON/OFF Foot Switch



Weight: 100g

Possible to make ON/OFF operation. Quick-stop circuit is incorporated to stop operation immediately at "OFF" mode.

KE50-113
Extension Curl Cord



Weight: 150g

Extension cable for handpieces (length 1.5m)
<NOTE> not available for Ultrasonic handpiece model US55

KE50-114/115
Extension Straight Cord



Weight: 115g

Extension cable for handpieces KE50-114 (length 3m) KE50-115 (length 5m)
<NOTE> not available for Ultrasonic handpiece model US55

Extension cable for Ultrasonic handpiece is also suppliable.

KP90-101
Handpiece Stand

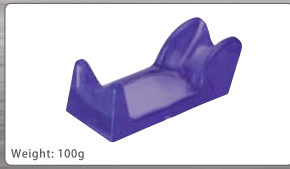

Weight: 100g

Made of elastic plastics to prevent the handpiece from dropping down.

PA31-748
Handpiece Holders



Weight: 150g

The angle of putting the handpiece can be adjusted at 0,45 & 90 degrees.

Collets

Interchangeable with
UT01 / UT02 / UT06 / UT07 / UT11 / UT12
UA12A / UA13A and UA14A.

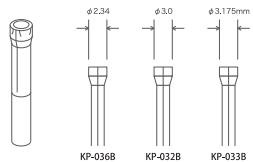

Interchangeable with UT03

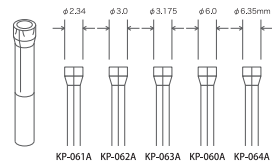

Interchangeable with UT05

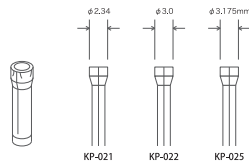

Model No.	Mounted Collet	Included Collet	Optional Collet	Model No.	Mounted Collet	Included Collet	Optional Collet
UT01 UT02 UA12A UA13A UA14A	φ2.34mm (KP-036B)	φ3.0mm (KP-032B)	φ3.175mm (KB-033B)	UT03	φ6.0mm (KP-060A)	φ3.0mm (KP-062A)	φ2.34mm (KB-061A)
			φ3.175mm (KB-063A)				φ6.35mm (KB-064A)
UT06 UT07 UT11 UT12	φ3.0mm (KP-032B)	φ2.34mm (KP-036B)	φ3.175mm (KB-033B)	UT05	φ3.0mm (KP-022)	φ2.34mm (KP-021)	φ3.175mm (KB-025)

A wrench is included for tool exchange.

System Chart

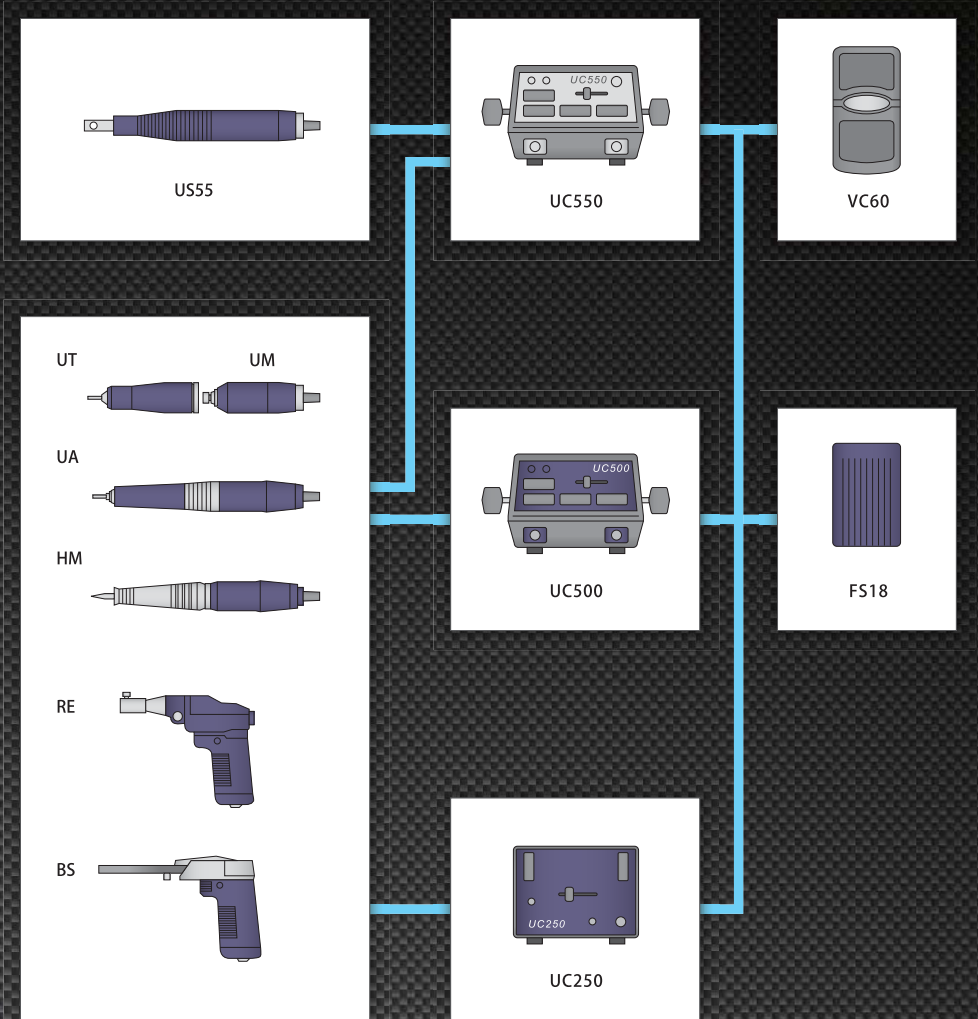

The brand name of "MINITOR" is officially registered by Urawa Corporation.

- The models belonged to "Uhandy" is succeeded by "URAWA MINITOR".
- All the models of "Uhandy" are interchangeable with those of "URAWA MINITOR".
- The specifications and designs in this catalogue are subject to change without notice.
- As the photograph is printed, the colors are slightly different from the actual ones.
- Please read the Operation Manual before using the equipment.